

REV	DESCRIPTION	DATE
A	ORIGINAL ISSUE	SEP 28 01

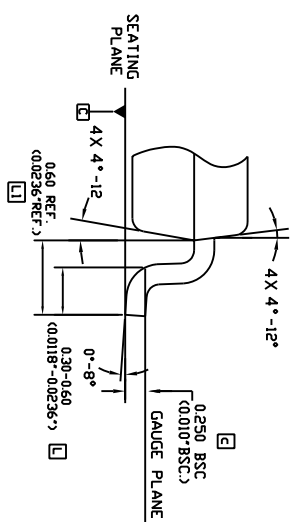

VIEW A

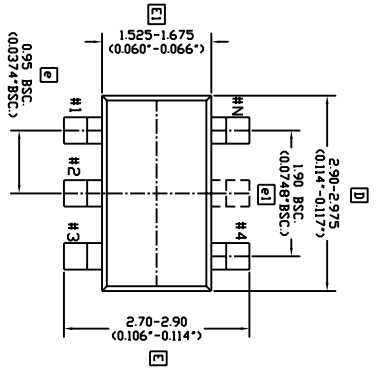
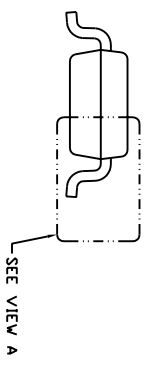
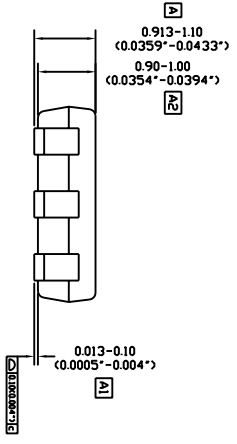

- NOTE :
1. Dimensioning and tolerancing per ASME Y14.5M-1994.
 2. Dimension D does not include mold flash, protrusions or gate burrs. Mold flash, protrusion or gate burrs shall not exceed 0.15 mm per side. Dimension E1 does not include interlead flash or protrusion. Interlead flash or protrusion shall not exceed 0.15 mm per side.
 3. Top package may be smaller than the bottom package. Dimension D and E1 are determine at the outermost extremes of the plastic body exclusive of mold flash gate burrs and interlead flash. reference only.
 4. Terminal numbers are shown for reference only. Die is facing up for molding. Die is facing down for trim/form.

		DRAWN BY: JEERAWIT S.	
		CHECKED BY: RACHAIN S.	
APPROVED BY: THANAPONG I.		APPROVED BY: VIJAI T.	
TITLE: TSDT23 S/6L PACKAGE OUTLINE DRAWING			
DATE: FEB 05 03	REF. NO.: MD-193-AA-AB	SCALE: NTS	
DWG. NO. W006FD-01	REV. B	SHEET 1	OF 1